

# Simple *Istep* operation

## Features

- **Easy one-step operation of a dedicated dropper**  
No need of specimen dilution by diluent such as developing reagent
- **Minimal operational errors**  
No need to count the drops of specimen
- **Good visibility by clear indication of decision line**

## IMMUNOCATCH™ *Streptococcus pneumoniae*

Rapid test for the detection of *Streptococcus pneumoniae* capsular antigen in urine and CSF specimens

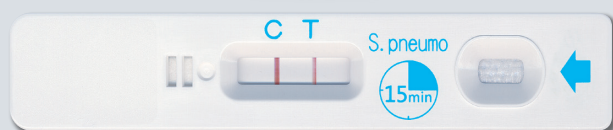

This photo depicts a positive sample (real scale).

## IMMUNOCATCH™ *Legionella*

Rapid test for the detection of *Legionella pneumophila* serogroup 1 LPS antigen in urine specimens



This photo depicts a positive sample (real scale).

### ■ Urine sample

#### Correlation with another product (immunochromatography method)

		Another product (Immunochromatography)		
		Positive	Negative	Total
IMMUNOCATCH™ <i>Streptococcus pneumoniae</i>	Positive	53	3	56
	Negative	1	137	138
	Total	54	140	194

Positive result consistency: 98.1% (53/54)  
Negative result consistency: 97.9% (137/140)  
Overall result consistency: 97.9% (190/194)

(In house data)

#### Correlation with another Product (immunochromatography method)

		Another Product (Immunochromatography)		
		Positive	Negative	Total
IMMUNOCATCH™ <i>Legionella</i>	Positive	50	0	50
	Negative	1	51	52
	Total	51	51	102

Positive result consistency: 98.0% (50/51)  
Negative result consistency: 100.0% (51/51)  
Overall result consistency: 99.0% (101/102)

(In house data)



EIKEN CHEMICAL CO., LTD.

Refer to the Instructions for Use attached to the product.

## Operation and method of determining the *Streptococcus pneumoniae* and *Legionella*

### SPECIMEN COLLECTION AND PREPARATION PROCEDURE

- ① Collect the specimen using urine cup, spitz, etc.

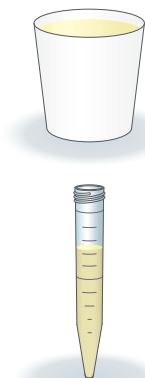

- ② Pinch the rubber ball portion of the supplied transfer pipette (dropper).

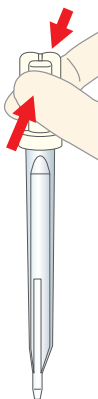

- ③ Slowly soak up 90µL or more of the specimen in a single collecting action using the dropper.

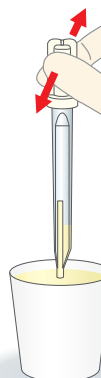

○ When you soak up slowly

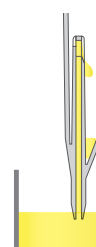

✗ When you soak up vigorously

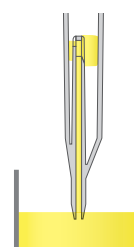

### TEST PROCEDURE AND RESULTS

#### TEST PROCEDURE

Drop the full volume of the specimen onto the sample site of the cassette in a single pipetting action. After dropping, excess specimen remains inside the dropper.

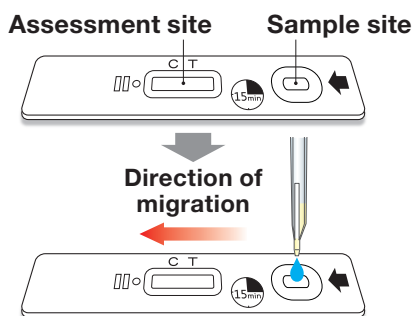

Drop **90 µL** of specimen

Leave the cassette for 15 minutes at room temperature (15-30°C)

#### RESULTS

Control line — Test line

Up to 15 minutes		→ <b>Positive</b>
At 15 minutes		→ <b>Negative</b>
At 15 minutes		→ <b>Invalid (Re-test)</b>
At 15 minutes		→ <b>Invalid (Re-test)</b>

#### CONTENTS (Common for *Streptococcus pneumoniae* and *Legionella*)

Cassette	20 tests
Positive control	1 × 1 mL
Negative control	1 × 1 mL
Transfer pipette	2 × 10 pcs

#### PRODUCT CODE, PRODUCT NAME & STORAGE

Product code	Product name	Contents	Storage	Period of validity
V-ET02	<b>IMMUNOCATCH™ <i>Legionella</i></b>	20 tests	1-30°C	2 years after production
V-ET04	<b>IMMUNOCATCH™ <i>Streptococcus pneumoniae</i></b>	20 tests	1-30°C	2 years after production

IVD

CE

EC REP

Advena Ltd.

Tower Business Centre, 2nd Flr., Tower Street,  
Swatar, BKR 4013 Malta



**EIKEN CHEMICAL CO., LTD.**  
4-19-9, Taito, Taito-ku, Tokyo 110-8408, Japan

4381

DMK

Apr.2019